

August 9, 2011

**ITEM#:** 7.E.

**RE:** DISCUSSION AND APPROVAL OF A BUDGET  
ALLOCATION FOR THE DESIGN AND CONSTRUCTION OF  
THE 200 SOUTH ACCESS ROAD AT THE GALLIVAN UTAH  
CENTER

**PROJECT AREA:** Central Business District Project Area

**PREPARED BY:** Jill Wilkerson-Smith

**FUNDING:** *Funding Needed: \$150,000*  
*Funding Available: \$350,000 – Gallivan Improvement Accounts*  
*(certain and uncertain)*

**EXECUTIVE SUMMARY:** Last month, the Board approved a new design of the 200 South Access Road, known as “Concept D” (attached). Staff has received a bid for the project from its general contractor Big-D Construction. To proceed with the new design, staff will need to draw funds from the Gallivan Improvements Account to fund the work.

**ALTERNATIVES:** 1. Approve the bid from Big-D and authorize staff to proceed with the work.  
2. Direct staff to obtain bids from other contractors and return to the Board with alternate bid prices.

**ANALYSIS AND ISSUES:** At the July Board meeting, the Board directed staff to obtain pricing from its general contractor, Big-D Construction, to construct a new design for the 200 South access road. The new access road would be a curbless extension of the plaza that would accommodate large-scale events and provide a pedestrian-friendly entry onto the north side of the Gallivan Center.

Staff received a bid from Big-D Construction for \$123,639 to construct the new road, and believes design fees will bring the cost total to approximately \$150,000. At this writing, staff is seeking EDA’s design costs to give the Board an exact figure. Staff is requesting the Board allocate up to \$150,000 for the project. The work will commence this fall and should take less than a month to complete.

**ATTACHMENTS:** Concept D: 200 South Access Road Design Rendering

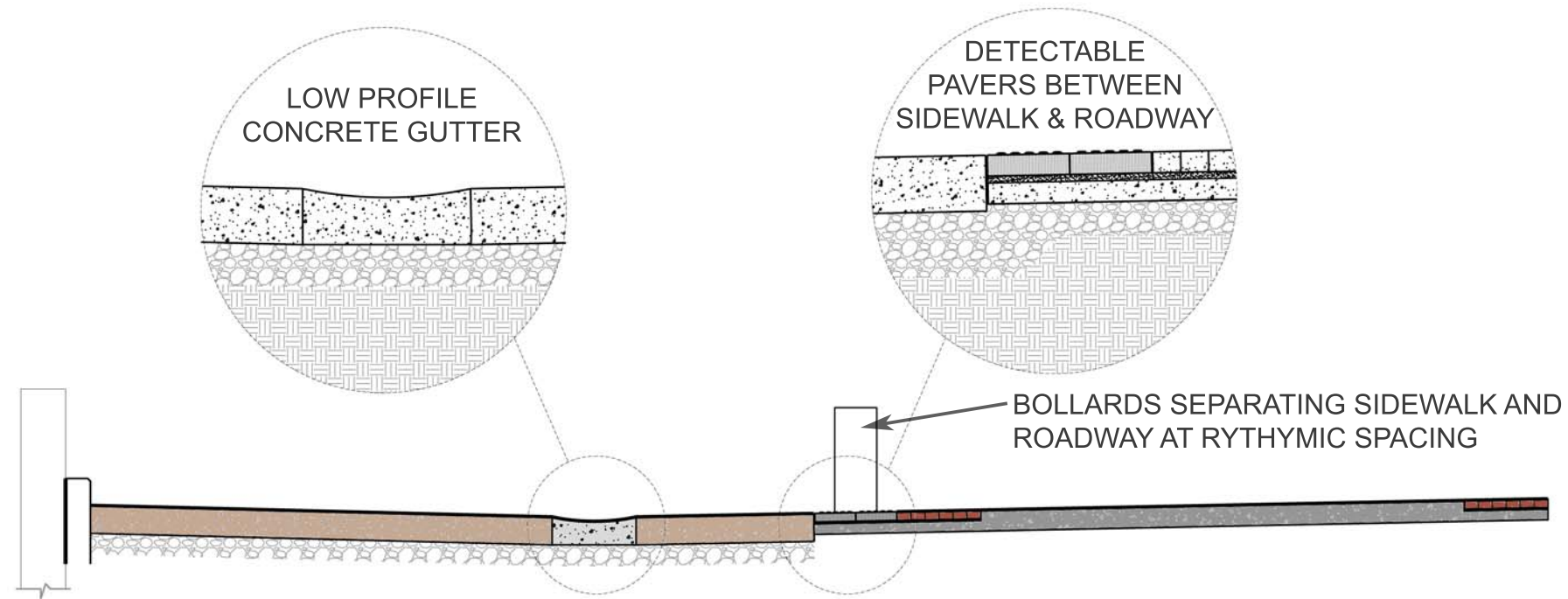

ROADWAY+SIDEWALK SECTION  
1/4"=1'-0"

**ROADWAY**  
CONCRETE COLORED & STAMPED TO EMULATE PLAZA PAVERS & PATTERN, SEPARATED FROM SIDEWALK BY CONTINUOUS DETECTABLE PAVERS AND BOLLARDS

**SIDEWALK**  
SALT LAKE CITY STANDARD CONCRETE WITH BRICK PAVER BORDER

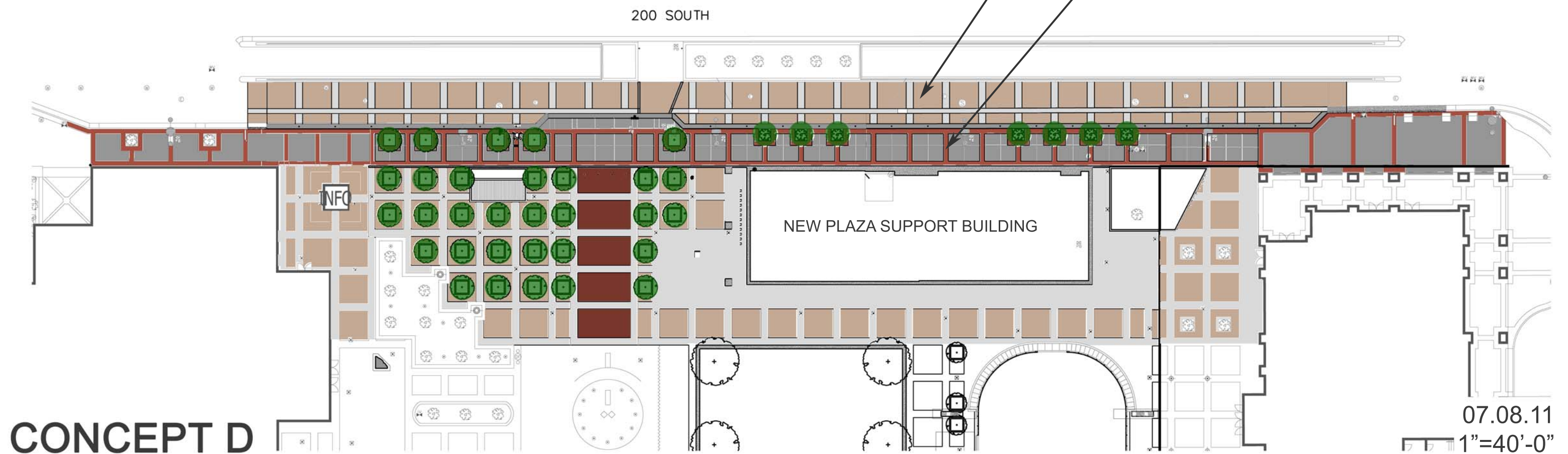

CONCEPT D